



A1 FIRE  
RATED



WATER  
RESISTANT



SOUND  
PROOF



# STS 18/22mm Construction Board TG4

A defence against **Fire, Water and Noise/Sound**

# BUILDING BETTER



# STS / Building Better

**A1**  
FIRE RATED



**WATER**  
RESISTANT



**TONGUE**  
& GROOVE



**FIX DIRECT**  
TO JOIST



**WEATHER**  
PROOF



**100%**  
RECYCLABLE



## Professionals choose **STS 18/22mm Construction Board TG4** for speed of fixing and peace of mind

### **A1 Fire Rated**

STS 18/22mm Construction Boards are the only boards you need for fire protection. They replace multiple boards and reduce fixing time.

### **Water Resistant**

Use STS 18/22mm Construction Boards for internal and external projects. These are boards that the weather can't damage on site, providing you a flexible building schedule.

### **No Squeaks**

Denser than chipboard, STS 18/22mm Construction Boards are robust and with tongue and groove edges, are less likely to generate squeaks and customer callbacks.

### **Easy to handle**

STS 18/22mm Construction Boards are available in 1200mm x 600mm sheets. Boards should always be carried on their edge to avoid unnecessary strain during handling.

### **Quick to fix**

Fix STS 18/22mm Construction Boards direct to joists using STS Mega Strength adhesive and 38mm screws. Cutting boards is easy with reduced dust using an STS PCD saw blade.



# STS 18/22mm Construction Board TG4 Installation

## 1. Cut boards to size

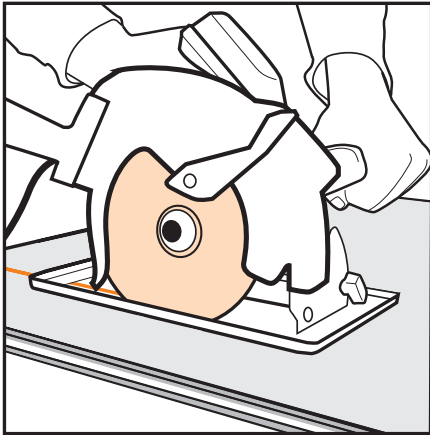

## 2. Stick board to joists

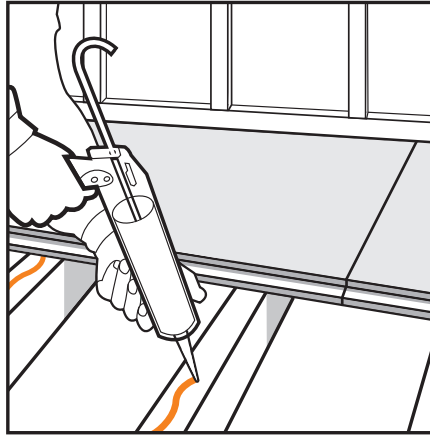

## 3. Screw board to joists

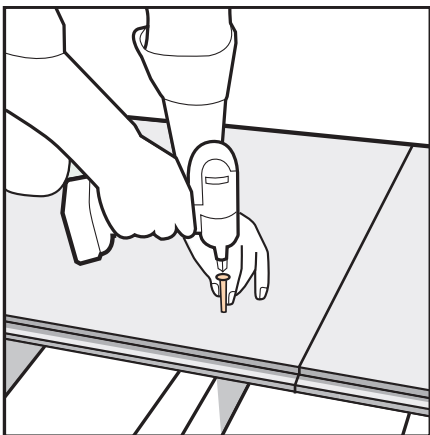

## 4. Seal between boards

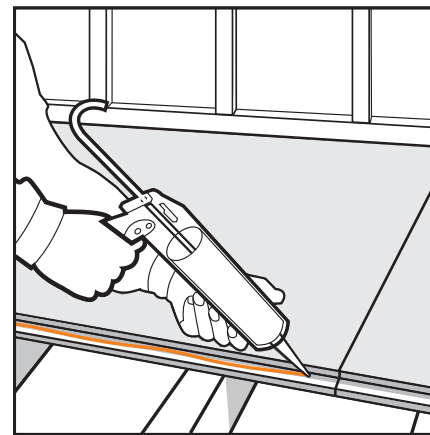

**REDUCE WASTE**

**NO NEED TO JOIN ON A JOIST!**



Cut it

Stick it

Screw it

## STS 18/22mm Construction Boards TG4

Cut STS 18/22mm Construction Boards using a circular saw fixed with vacuum extractor and an STS PCD saw blade. This method will cut boards easily and mitigate dust.

STS 18/22mm Construction Boards can be fixed to timber or steel joists installed at maximum 600mm centres.

To achieve an acceptable finish, it is important that floor joists are level.

Apply a bead of STS Mega Strength adhesive to the joist, then position the first floor board.

Secure with 12 x 38mm STS Drill Tip screws, placed a minimum of 12mm from the square edge and 5mm from the side of the joist.

Ensure screws are placed a minimum distance of 25mm from the tongue and groove edge.

STS 18/22mm Construction Boards should be laid out in a brick bond pattern. T&G joints do not need to end on a joist but all short, square edges should be fully supported.

Secure subsequent 18/22mm Construction Boards by applying MegaStrength along the length of the board's groove, before inserting the tongue of the next board.

Clean off any surplus adhesive with a damp cloth.

STS 18/22mm Construction Boards are ready to tile or install other surface finish immediately.



# 18/22mm Technical Data (22mm x 1200mm x 600mm) (18mm x 1200mm x 600mm)

## General information

**Description:** The 18mm and 22mm STS Tongue and Groove panels are used for installing floor substrates on metal or timber structures. They can safely resist the efforts generated by temporary and permanent loads. Any type of floor can be installed on them. They have tongue and groove joint edges that guarantee the mechanical joint between panels.

## Product components

Portland cement, cellulose fibers, sand, water and other minor aggregates. The panels fulfill the requirements of resistance, safety, and durability required in the construction of buildings, as well as the most stringent environmental regulations. When exposed to moisture the STS Construction Board T & G 18/22mm doesn't change shape, rot or expand like chipboard, plywood and other timber-based materials. Fully compatible with most types of tile adhesives, timber adhesives such as MS polymers PU Acrylic etc. Accepts ceramic tiles timber flooring etc please contact our technical department for further compatibility information.

## Storage

STS recommends that the board be stored and handled in a manner to prevent deterioration and damage. The product should be protected from atmospheric actions, excessive humidity and temperature changes, such as rain, sun, winds and moisture. STS boards must always be stored flat. If boards are stored outside they must always be fully covered with a waterproof tarpaulin.

## Acclimatisation

STS 18mm and 22mm boards must be protected from moisture & weather prior to installation. Although they will not deteriorate after installation even if subject to adverse weather conditions, it is recommended that if this is likely to happen a coat of waterproof primer such as SBR will reduce moisture ingress.

Before the final finish is laid boards should be thoroughly cleaned & allowed to acclimatize to the final ambient temperature & moisture conditions of the building. If piped underfloor heating is installed this can be turned on to assist with acclimatization.

## Technical Specifications

Description	Minimum Value	Maximum Value
Flexural strength - dry (N/mm <sup>2</sup> ) ISO 8336	7.0	
Elastic module - dry (kN/mm <sup>2</sup> ) ISO 8336	2.5	4.0
Density (kg/m <sup>3</sup> ) ISO 8336	1,125	1,300
Moisture (%) ISO 8336		10
Total absorption (%) ISO 8336		40
Superficial absorption (%) ISO 8336		25
Moisture movement (mm/m) ISO 8336		1.3
Total contraction (mm/m) Own procedure		4.0
Smoke development (ASTM E - 84)	0	
Flame spread (ASTM E - 84)	0 - Class 1	

## Nominal Dimensions

Dimension	SKU: 5522	SKU: 5518	Tolerance
Thickness	22mm	18mm	± 5%
Width	600mm	600mm	± 1- 2%
Length	1200mm	1200mm	± 1- 2%
Weight	24.85kg	18.85 kg	-
Covering per unit (m <sup>2</sup> )	0.72 m <sup>2</sup>	0.72 m <sup>2</sup>	-

## Need futher support?

For more information regarding the tolerance of our boards please call us on the number below.

## Advantages

- T&G on all 4 sides with unique design for easy fit
- Can be cut with PCD blade and screwed with drill-tipped screws
- Provides insulation to noise & heat
- Easy to lay with minimal waste
- Moisture resistant
- T&G joins do not have to end on a joist
- Fire resistant
- 100% recyclable

**0113 202 2010**  
[sales@sts-uk.com](mailto:sales@sts-uk.com)  
 visit: [sts-uk.com](http://sts-uk.com)

**STS**